

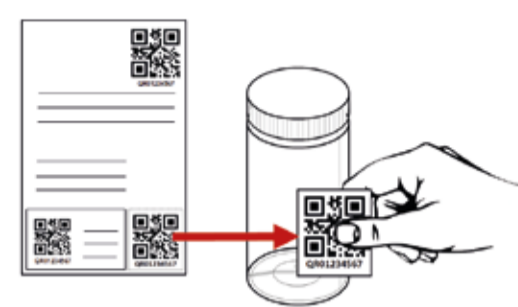

SAMPLE SUBMISSION USING **WEBCHECK** APP

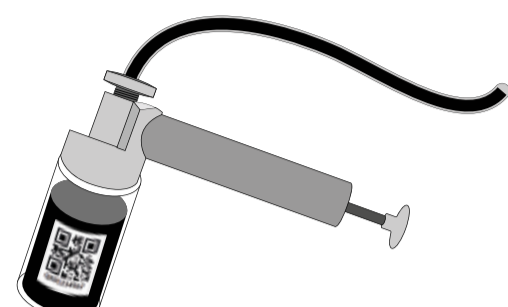

Remove the sample label from the sample form and stick to the sample bottle.



Take the oil sample as you normally would and re-cap the sample bottle.



Ensure that the cap is securely tightened and wipe any excess oil from the sample bottle.



Using the app, scan the QR code of the machine the sample was taken from. Remove the tracking label from the sample form and stick to the asset log booklet.



Next, scan the sample label, and complete the sample information and submit the sample.

Introducing **WebCheck**, the new oil analysis management platform developed by the multidisciplinary team of experts at WearCheck International is an intuitive and simple platform that provides you with all the information, trends, and maintenance recommendations you need to keep your equipment in top condition. With a focus on reliability and efficiency, the WebCheck v2 platform takes your equipment maintenance to the next level, all from the comfort of your phone, tablet, or laptop. Let's begin from the start! In this infographic, we present all the necessary steps required to execute the sampling process efficiently.

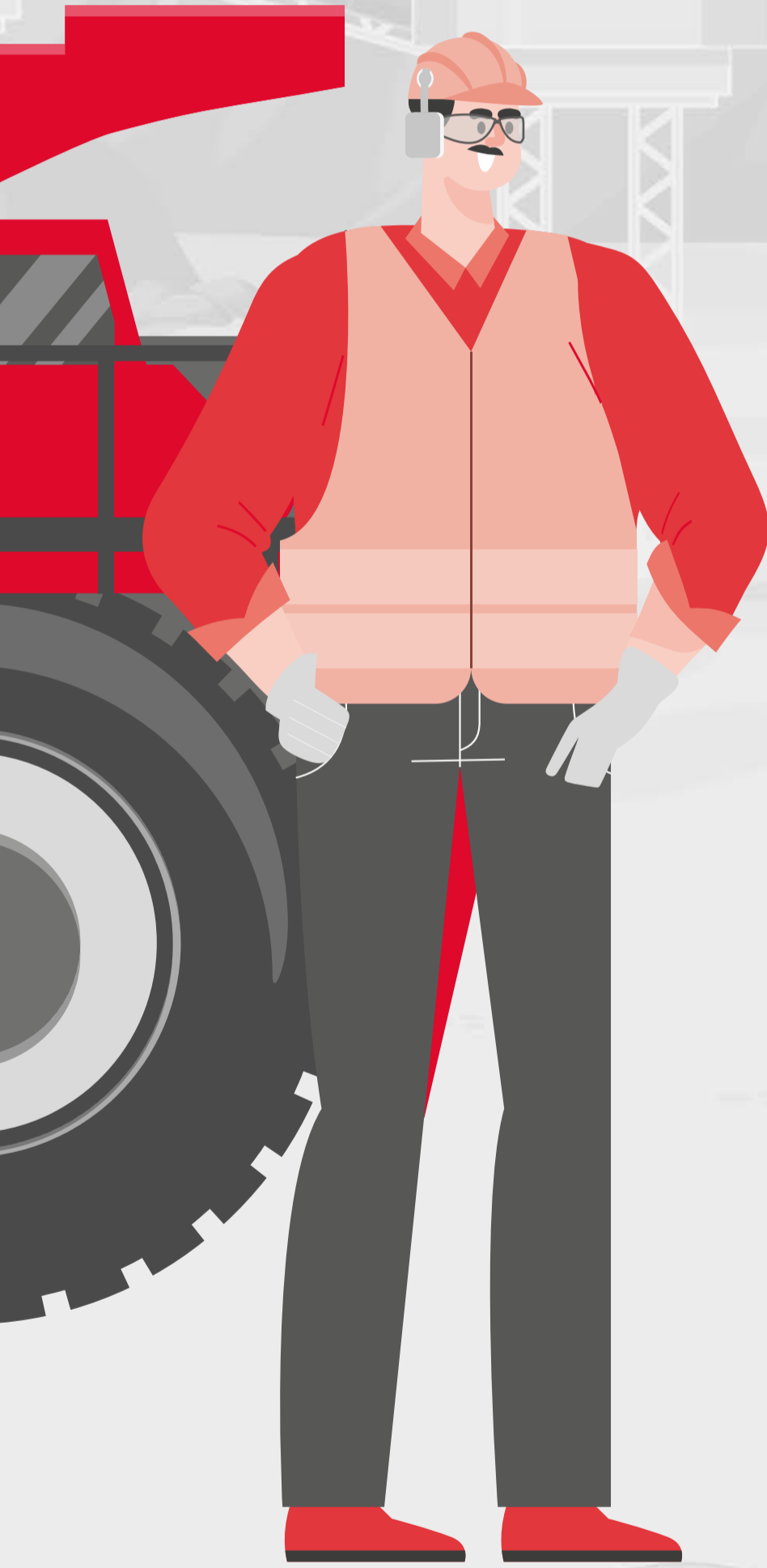

1

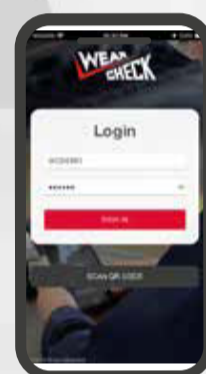

Login to the app using your WebCheck credentials. The app will cache your machines.

2

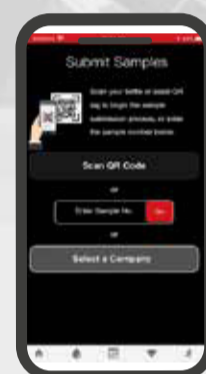

Once logged in, click on the "Scan QR Code" button.

3



Locate the machine that was sampled in the asset tag booklet and scan that QR code.

4



The asset is selected & sample submission screen is loaded. Click the "Scan" button.

5



Scan the sample bottle label from your oil sample for the selected machine.

6



The sample is now linked to the machine. Use the "SIMPLE" data entry mode to add info.

7



Select the sample date, take any pictures you want, add a comment if desired, then click the "submit sample" button.

8

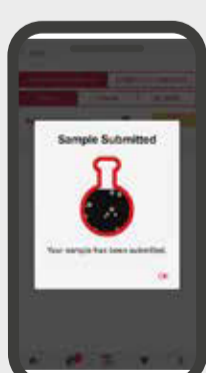

The sample info has been submitted to the laboratory where the QR code will be scanned, and the sample information automatically retrieved.

9

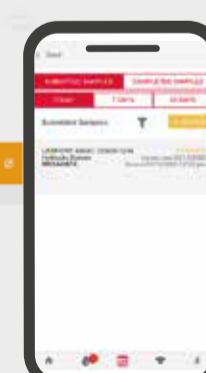

Submitted samples are listed. To update a samples info slide right. To delete a sample slide left.

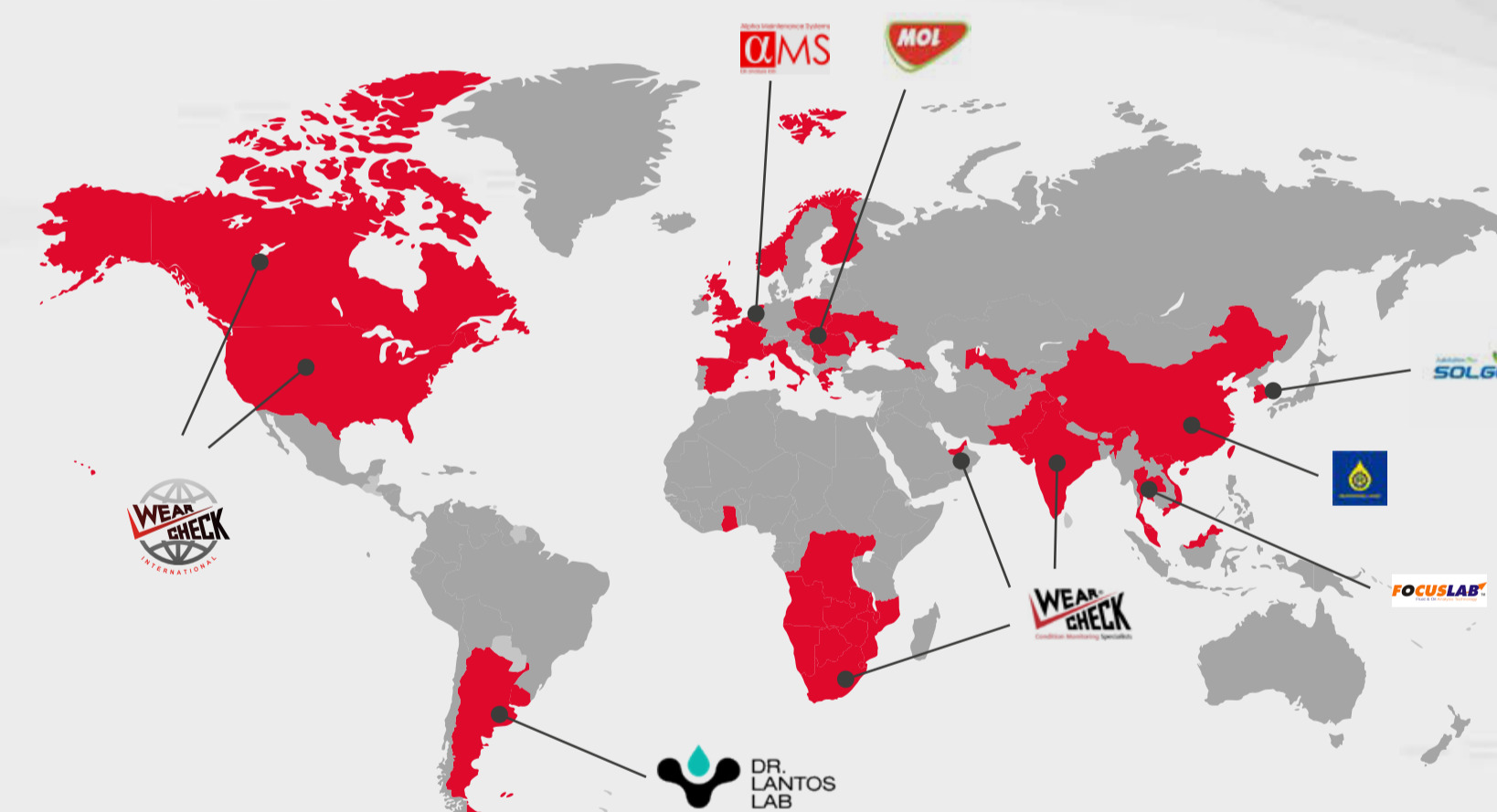
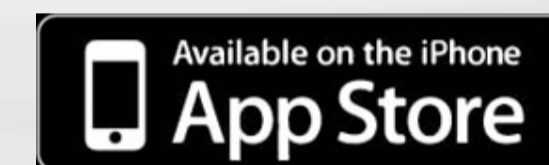

WearCheck is a group of independent laboratories, spanning the globe, dedicated to oil and wear particle analysis. Each member country belongs to the WearCheck International (WCI). WCI is a consortium of laboratories guided by the WCI charter. The WCI charter outlines the necessary requirements to be a member of WCI, and includes specifications for testing capability, quality, and service.

